

# COLORSTAGE

## GLOWA RUCHOMA LED BEAM SPOT WASH SPIKIE



This manual contains important information. Please read before operating fixture.

# 1 SECURITY TIPS

**WARNING!!!** To reduce the risk of fire, electric shock, or injury to persons, follow these important safety instructions:

non-professionals, not to disassemble the light arbitrarily and lighting accessories inside.

rated voltage range: AC110V-120V/60Hz or AC200V-240V / 50HZ (to be selected).

not beam irradiate the flammable materials, flammable materials and the lamp should be maintained at least 1M over the distance.

lamps used in ambient temperature: -15 °C -40 °C, the highest temperature of the surface of the lamp: 60 °C.

to keep away from the liquid substance and humid environment.

before using the lights must ensure the good grounding, can not install charging and remove any parts.

the installation of lamps, must be fixed screw fasteners with additional security cable and regular inspection.

lamps consecutive working hours is not recommended more than 10 hours. should stop using the lights in time when happens unusual conditions during the process

lamp parts of the rotation, external accessories and paste parts should be regular inspected, such as the emergence of loose and rock, should be reinforced in a timely manner to prevent the accident.

lamps adopt strong winds to refrigerate, it is easy to accumulate the dust, so you have to clean it weekly especially the cooling air opening, otherwise the dust will plug leading to poor light

## 2 TECHNOLOGY REFERENCE

Input Voltage: AC100-240V 50/60Hz

Power:

Light source: 60W RGBW 4in1 LED

Color temperature: 2700K and 3200K

LED life expectancy: min,20000 hrs

Zoom range: 4°-28°

Color mixing mode RGBW

Strobe: Strobe effect with variable speed(0.3-20Hz)

Dimmer: Smooth dimmer from 0-100%

Prism: 3-facet rotating prism with continuous rotation in both direction

Effect: Flower effect, color rainbow effect, 3 facet prism 10 flower effect macros

Pan movement range: 540°(switchable to 360°) 16bit

Control mode: DMX512, master-slave, auto, sound, stands-alone

DMX channel: 27/21ch

Function: Beam, Wash, Spot, Samll and working fast

Product size: 290\*130\*395mm

Net weight: 10.5kg

Pan/Tilt: 360 degree continus rotation control

### 3 Board Instruction

Setup	ADDRESS	001-512
	Show ID	1-255
	Run Mode	DMX512,Sound,Auto
	Master/Slave	Master mode/Slave mode
	Return	
Option	Language	Chinese/English
	Channel	27CH/21CH
	Reset	Yes/No
	Default SET	Yes/No
	Pan Invert	Yes/No
	Tilt Invert	Yes/No
	Display Invert	Yes/No
	Display Saver	Yes/No
	Return	
Adj Set	0-999	
Test		
About	Display Ver:2.2 Holder Control:1.0 Pan/Tilt Control:1.0 Use Of Time: 56H 50M	
Return		

## 4 DMX protocol

Mode/Channel		DMX Valus	Function	Type of Control
27ch	21ch			
1	1	0-255	Pan(8 bit) Pan movement by 540° /360° (128=default)	Proportional
2	2	0-255	Pan Fine(16 bit)	Proportional
			Fine control of pan movement(0=default)	
3	3	0-255	Tilt(8 bit)	Proportional
			Tilt movement by 360° (128=default)	
4	4	0-255	Tilt fine(16 bit)	Proportional
			Fine control of tilt movement(0=default)	
5	5		Pan Control	
		0	Pan range 540°, shortcut off(0=default)	step
		1	Pan range 360°, shortcut on	step
		2-127	No function(Pan range 540°, shortcut off)	
		128-189	Continuous rotation fast->slow,Forwards	Proportional
		190-193	Stop rotation	step
		194-255	Continuous rotation slow->fast,Backwards	Proportional
6	6		Tilt control	
		0	Tilt range 360°, shortcut off(0=default)	step
		1	Tilt range 360°, shortcut on	step
		2-127	No function(Tilt range 360°, shortcut off)	
		128-1	Continuous rotation fast->slow,Forwards	Proportional

		89		nal
		190-193	Stop rotation	step
		194-255	Continuous rotation slow->fast,Backwards	Proportional
7	7		Pan/Tilt speed,Pan/Tilt time	
		0	Max.speed-tracking mode(0=default)	step
			Pan/Tilt speed	
		1-255	Speed from max to min(vector mode)	Proportional
			Pan/Tilt time	
		1-255	Time from 0.1s to 25.5 sec	Proportional
8	8	Reset		
9	9		Virtual colour wheel	
		0-4	Amber	step
		5-9	Orange	step
		10-14	Dark orange	step
		15-19	Red	step
		20-24	Medium pink	step
		25-29	Sky blue	step
		30-34	Light amber	step
		35-39	Green	step
		40-44	Dark yellow green	step
		45-49	Dark green	step
		50-54	Purple	step
		55-59	Warm white	step
		60-64	Deep yellow	step
		65-69	Pale yellow	step
		70-74	White	step
		75-79	Bright green	step
		80-84	Flame red	step
		85-89	Pink	step

		90-94	Day light blue	step
		95-99	Pale rose	step
		100-104	Cold white	step
		105-109	Pale navy blue	step
		110-114	Red	step
		115-119	Green	step
		120-124	Blue	step
		125-129	Pale white	step
		130-134	Blue	step
		125-129	Pale white	step
		130-134	Warm white	step
		135-139	Cool white	step
		140-144	Fluorescent green	step
		145-149	Special lavender	step
		150-154	Alice blue	step
		155-255	Color change from slow to fast	step
10	10		Red/Cyan(8 bit)	
		0-255	Colour saturation control-coarse 0-100%(255=default)	Proportional
11	*		Red/Cyan(16 bit)	

		0-255	Colour saturation control-fine(255=default)	Proportional
12	11		Green/Magenta (8 bit)	
		0-255	Colour saturation control-coarse 0-100%(255=default)	Proportional
13	*		Green/Magenta (16 bit)	
		0-255	Colour saturation control-fine(255=default)	Proportional
14	12		Blue/Yellow (8 bit)	
		0-255	Colour saturation control-coarse 0-100%(255=default)	Proportional
15	*		Blue/Yellow (16 bit)	
		0-255	Colour saturation control-fine(255=default)	Proportional
16	13		White(8 bit)	
			If RGBW mode is selected:	
		0-255	Colour saturation control-coarse 0-100%(255=default)	Proportional
			If CY mode is selected:	
		0-255	No function	
17	*		White(16 bit)	
		0-255	Colour saturation control-fine(255=default)	Proportional
18	14		CTC	
			If function' white point 8000k ' is ON	
		0-255	Col.temperature correction from 8000k to 2700k-for whites only	Proportional
			(0=8000k,64=5600k,128=4200k,192=3200 k,255=2700k)	
			To get colour temperature stated above,RGBW channels have to be set at the same value e,g 255DMX (0=default))	
			(To activate tungsten effect at 2700k and 3200k,set DMX value at' power/special	



			function' channel)	
			If function' white point 8000k' is off	
		0-255	Colour temperature correction for from cool white to 2700K	Proportio nal
19	15		Colour Mix control	
			Defines relation between colour channels	
			Virtual=virtual colour (virtual colour wheel)	
			Colour mix=colour channels(RGBW/CMY)	
		0-9	Virtual colors( virtual has priority)	step
		10-19	Maximum mode(highest values have priority)	step
		20-29	Maximum mode(lowest values have priority)	step
		30-39	Multiply mode(multiply virtual and colour mix)	step
		40-49	Addition mode(Virtual+colour mix)/45=default/	step
		50-59	Subtraction mode(Virtual-colour mix)	step
		60-69	Inverted subtraction mode(Virtual-colour mix)	
		70-128	Reserved	
		129	Virtual colors(virtual has priority)	step
		130-254	Crossfade(crossfade between virtual and colour mix)	Proportio nal
		255	Colour channels(colour mix has priority)	step
20	16		Rotating Prism	
		0	Open position-without prism(0=default)	step
		1-127	Prism inserted,forwards rotation from fast to slow	Proportio nal
		128	No rotation-prism inserted	step
		129-255	Prism inserted,backwards rotation from slow to fast	Proportio nal

21	17		Flower Effect	
		0	Open position-without flower effect(0=default)	
		1-127	Flower effect on,forwards rotation from fast to slow	
		128	Flower effect on,no rotation	
		129-255	Flower effect on,backwards rotation from slow to fast	
22	18		Flower effect&Rotating prism macros	
		0	Open position-without macros(0=default)	step
			In range of 1-20DMX,channels rotation prism and flower effect are blocked	
		1-2	Macro 1	step
		3-4	Macro 2	step
		5-6	Macro 3	step
		7-8	Macro 4	step
		9-10	Macro 5	step
		11-12	Macro 6	step
		13-14	Macro 7	step
		15-16	Macro 8	step
		17-18	Macro 9	step
		19-20	Macro 10	step
		21-255	Reserved	
23	19		Zoom	
		0-255	Zoom from max to min.beam angle(128=default)	Proportional
24	*		Zoom -fine	
		0-255	Fine zooming(0=default)	Proportional
25	20		Shutter/Strobe	
		0-31	Shutter closed	step
		32-63	Shutter open(32=default)	step

		64-95	Strobe-effect from slow to fast	Proportional
		96-127	Shutter open	step
		128-143	Opening pulse in sequences from slow to fast	Proportional
		144-159	Opening pulse in sequences from fast to slow	Proportional
		160-191	Shutter open	step
		192-223	Random strobe-effect from slow to fast	Proportional
		224-255	Shutter open	step
26	21		Dimmer intensity(8 bit)	
		0-255	Dimmer intensity from 0% to 100%(0=default)	Proportional
27	*		Dimmer intensity-fine(16 bit)	
		0-255	Fine dimming(0=default)	Proportional

## 6 FIXED EQUIPMENT

Please keep the equipment far away from the flammable objects like finishing material, etc. keep at least 0.5m distance from the flammable objects.

Warning: using two lamp clamps fix the equipment on the bottom of the lamp holder according to the instruction. to make sure the place of install the lamp is safe and suitable ,and the installation point that have chosen is safety and reliable.

The place of installing the lamp must support the 10 times weight of the lamp itself. And test the pensile place and make sure the place isn't out of the shape.

Must install the second protection when fixing the equipment like proper protective screening. The second protection is used to prevent drop off and lost of lamp and components.

Lamps can directly install the lamp holder , which is shown in the

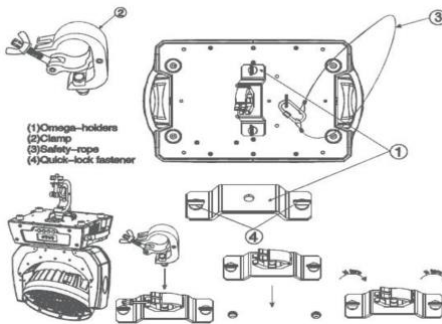

figure: